

ORFORD CASTLE

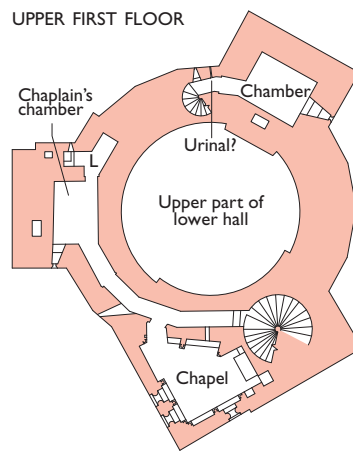

1165-72
 Modern
 No visitor access
 L = Latrine
 Pale shades indicate conjectural walls

0 10 metres
 0 25 feet

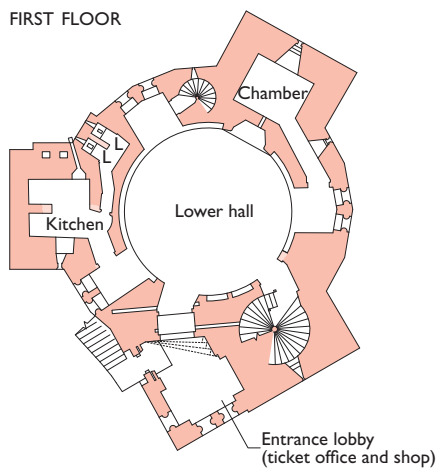
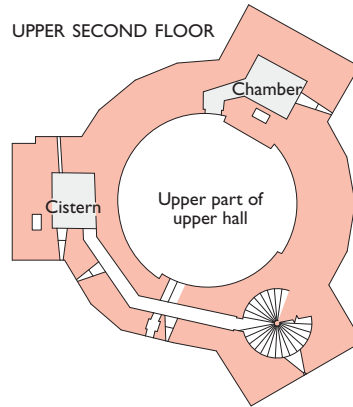
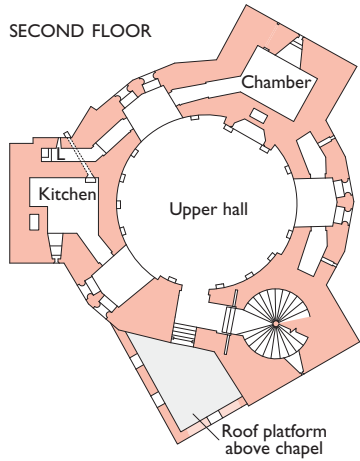
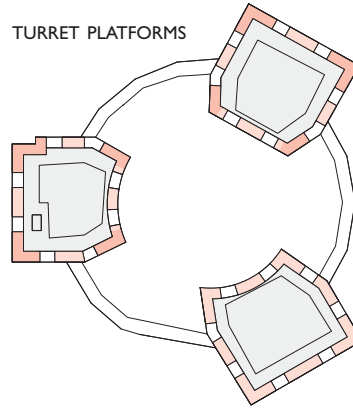
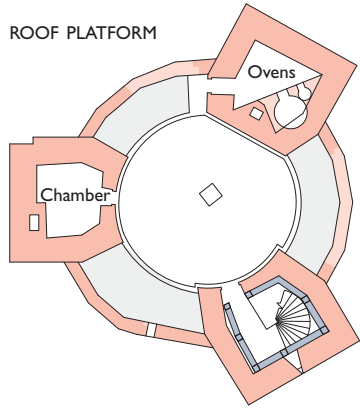
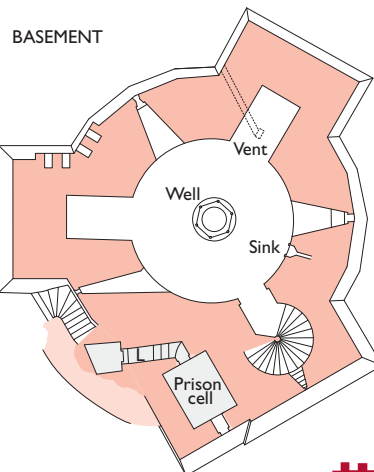

ORFORD CASTLE – SITE PLAN

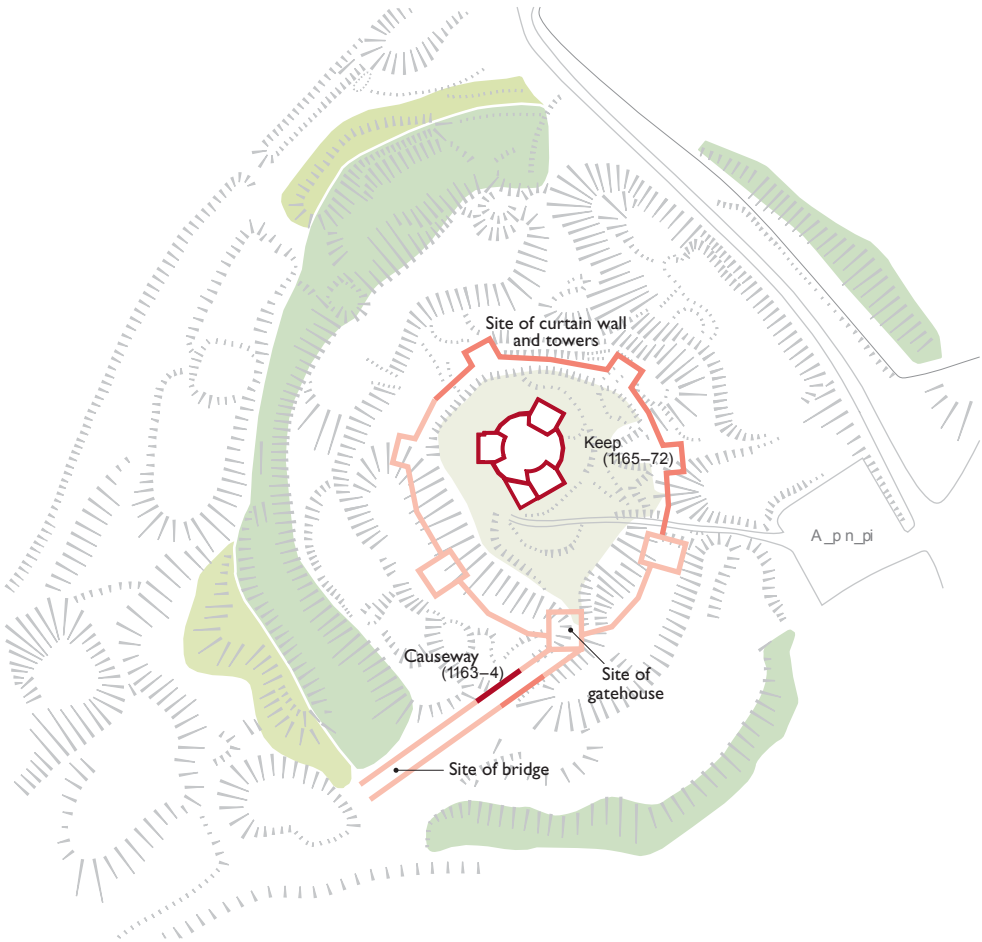

- █ Surviving structures
- █ Walls based on archaeological evidence (not visible), presumed contemporary with keep
- █ Presumed position of walls, based on Norden's illustration of c.1601
- █ Surviving extent of bailey
- █ Remains of the outer bank (1172-3)
- █ Remains of the outer ditch (1172-3)

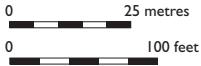

This drawing is The English Heritage Trust copyright and is supplied for the purposes of private research. It may not be reproduced in any medium without the express written permission of The English Heritage Trust.
September 2020



ENGLISH HERITAGE